

High Current Inductor



SIFP, a new design in solid structure for better reliability



FEATURES

- High current and precision Rdc
- Ferrite core
- RoHS, Halogen free and REACH compliance

APPLICATION

- Server, workstation and storage systems
- Desktop and notebook
- Graphics cards and battery power systems
- Multi-phase and Vcore regulators
- Voltage Regulator Modules (VRMs)
- Point-of-Load modules
- DCR Sensing circuits

ENVIRONMENTAL DATA

- Storage temperature range: -40°C to +125°C
- Operating temperature range: -40°C to +125°C (ambient + self-temperature rise)
- Reflow soldering temperature: J-STD-020D compliance
- MSL level 1

PACKAGING

- SIFP0606 : 500pcs/reel, 2000pcs/carton (Ref)
- SIFP0607 : 500pcs/reel, 2000pcs/carton (Ref)
- SIFP0710 : 500pcs/reel, 2000pcs/carton (Ref)



Dimension (Unit:mm):

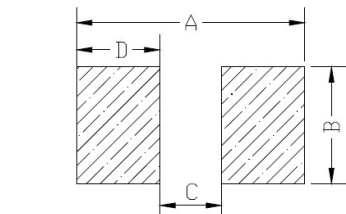

Recommended Land Pattern (Unit:mm):

SERIES	A ±0.3	B ±0.3	C Max	D ±0.3	E ±0.3
SIFP0606	6.4	6.4	Refer table below	3.5	1.7
SIFP0607	7.8	6.0		2.1	2.0
SIFP0710	10.4	7.0		2.5	2.8

A ref	B ref	C ref	D ref
7.3	4.5	1.9	2.7
8.8	3.1	2.8	3.0
11.5	3.4	3.7	3.9

0606 SERIES

Part Number	Inductance/μH ±20%	Rdc/mOhms ±10%	Isat/A ΔL-30%(typ)		Irms/A ΔT+40°C(typ) T _{amb} =25°C	Thickness C Max
			T _{amb} =25°C	T _{amb} =125°C		
SIFP0606CE-R065M-XXXX	0.065	0.16	40	30	35	3.5
SIFP0606EZ-R10M-XXXX	0.10	0.23	40	30	35	5.0
SIFP0606FZ-R12M-XXXX	0.12	0.17	40	30	35	6.0
SIFP0606FH-R15M-XXXX	0.15	0.20	40	30	35	6.8
SIFP0606HC-R18M-XXXX	0.18	0.23	40	30	35	8.3
SIFP0606JC-R22M-XXXX	0.22	0.29	40	30	35	10.3

0607 General Series

Part Number	Inductance/ μ H	Rdc/mOhms	Isat/A		Irms/A	Thickness C
			$\Delta L-30\%$ (typ)			
	$\pm 20\%$	$\pm 10\%$	$T_{amb}=25^{\circ}\text{C}$	$T_{amb}=125^{\circ}\text{C}$	$T_{amb}=25^{\circ}\text{C}$	Max
SIFP0607EZ-R12M-XXXX	0.12	0.32	45	30	35	5.0
SIFP0607FZ-R15M-XXXX	0.15	0.32	45	30	35	6.0
SIFP0607FE-R18M-XXXX	0.18	0.40	45	30	35	7.0
SIFP0607GH-R22M-XXXX	0.22	0.45	45	30	35	7.8
SIFP0607JE-R30M-XXXX	0.30	0.63	45	30	35	10.5

0607 Higher Saturation Series

Part Number	Inductance/ μ H	Rdc/mOhms	Isat/A		Irms/A	Thickness C
			$\Delta L-30\%$ (typ)			
	$\pm 20\%$	$\pm 10\%$	$T_{amb}=25^{\circ}\text{C}$	$T_{amb}=125^{\circ}\text{C}$	$T_{amb}=25^{\circ}\text{C}$	Max
SIFP0607EZ-R10M-XXXX	0.10	0.32	55	40	35	5.0
SIFP0607FZ-R12M-XXXX	0.12	0.40	55	40	35	6.0
SIFP0607GZ-R15M-XXXX	0.15	0.47	55	40	35	7.0
SIFP0607GE-R18M-XXXX	0.18	0.47	55	40	35	7.5
SIFP0607IE-R22M-XXXX	0.22	0.55	55	40	35	9.5

0710 General Series

Part Number	Inductance/ μ H	Rdc/mOhms	Isat/A		Irms/A	Thickness C
			$\Delta L-30\%$ (typ)			
	$\pm 20\%$	$\pm 10\%$	$T_{amb}=25^{\circ}\text{C}$	$T_{amb}=125^{\circ}\text{C}$	$T_{amb}=25^{\circ}\text{C}$	Max
SIFP0710DZ-R12M-XXXX	0.12	0.17	45	30	40	4.0
SIFP0710EZ-R15M-XXXX	0.15	0.23	45	30	40	5.0
SIFP0710FZ-R18M-XXXX	0.18	0.29	45	30	40	6.0
SIFP0710GZ-R22M-XXXX	0.22	0.32	45	30	40	7.0
SIFP0710HZ-R25M-XXXX	0.25	0.37	45	30	40	8.0
SIFP0710IZ-R30M-XXXX	0.30	0.40	45	30	40	9.0
SIFP0710JZ-R36M-XXXX	0.36	0.43	45	30	40	10.0

■ 0710 Higher Saturation Series

Part Number	Inductance/ μ H	Rdc/mOhms	Isat/A		Irms/A	Thickness C
			$\Delta L-30\%$ (typ)			
	$\pm 20\%$	$\pm 10\%$	$T_{amb}=25^{\circ}C$	$T_{amb}=125^{\circ}C$	$T_{amb}=25^{\circ}C$	Max
SIFP0710EZ-R12M-XXXX	0.12	0.23	60	45	40	5.0
SIFP0710FZ-R15M-XXXX	0.15	0.28	60	45	40	6.0
SIFP0710GZ-R18M-XXXX	0.18	0.32	60	45	40	7.0
SIFP0710HZ-R22M-XXXX	0.22	0.35	60	45	40	8.0
SIFP0710GE-R25M-XXXX	0.25	0.4	60	45	40	9.0
SIFP0710HZ-R30M-XXXX	0.30	0.43	60	45	40	10.0

- Inductance is measured with a LCR meter E4980AL (Agilent technologies) or equivalent at 100KHz, 1Vrms, 0Adc, 25°C.
- DC resistance is measured with 16502 miliohmmeter (Reference ambient temperature 25°C).
- Inductance decrease current is measured with 3302 automatic component analyzer and 1320 bias current source (Chroma technologies).
- IRMS: The current will cause self-temperature rise approximately 40°C.
- ISAT: The current will cause L_0 to drop approximately 30%.

APPLUCATION NOTES:

- Shelf storing temperature $-5^{\circ}C \sim +40^{\circ}C$, Humidity 20% to 70%RH, keep away from chemical, dust, acid gas like sulfide & chloride gas and avoid expose direct to sunlight.

NOTICES:

- Product characteristics and tolerance can be adjusted per request. Others size and inductance is available for inquiry. Specifications are subject to change without notice. Please contact our sale for latest information.
- These products are not designed for use in applications where any failure or malfunction may resulted in personal injury, death or severe property or environmental damage such as medical, military, aircraft, space or life support equipment.